

**Combination / Slotted**

Part Number	Drive Size	A inch/mm	B inch/mm	Penetration inch/mm	OD inch/mm	Length inch/mm
7TXI-175	T7	.082/2.08	.060/1.52	.031/.079	0.438/11.13	1.00/25.40
8TXI-175	T8	.095/2.41	.069/1.75	.041/1.04	0.438/11.13	1.00/25.40
8TXI-176	T8	.095/2.41	.069/1.75	.041/1.04	0.438/11.13	1.00/25.40
9TXI-175	T9	.102/2.59	.074/1.88	.040/1.02	0.438/11.13	1.00/25.40
10TXI-175	T10	.111/2.81	.081/2.05	.051/1.30	0.563/14.30	1.00/25.40
10TXI-176	T10	.111/2.81	.081/2.05	.051/1.30	0.563/14.30	1.00/25.40
15TXI-175	T15	.132/3.35	.096/2.43	.045/1.14	0.563/14.30	1.00/25.40
20TXI-175	T20	.155/3.93	.112/2.85	.060/1.52	0.563/14.30	1.00/25.40
25TXI-175	T25	.178/4.53	.129/3.27	.075/1.91	0.875/22.23	1.00/25.40
27TXI-175	T27	.200/5.09	.144/3.67	.075/1.91	0.875/22.23	1.00/25.40
30TXI-175	T30	.221/5.62	.160/4.06	.090/2.29	0.875/22.23	1.00/25.40
40TXI-175	T40	.267/6.78	.192/4.89	.110/2.29	0.875/22.23	1.00/25.40
45TXI-175	T45	.313/7.95	.224/5.68	.140/3.56	1.00/25.4	1.00/25.40
50TXI-175	T50	.353/8.96	.256/6.50	.154/3.91	1.25/31.75	1.00/25.40
55TXI-175	T55	.447/11.35	.318/8.09	.175/4.45	1.25/31.75	1.00/25.40

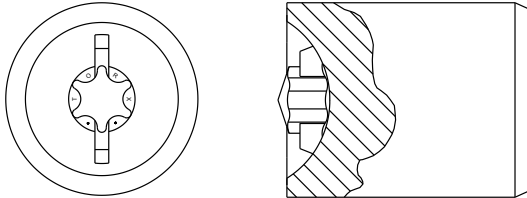

**Flat Head**

Part Number	Drive Size	A inch/mm	B inch/mm	Penetration inch/metric	OD inch/mm	Length inch/mm
1TXI-275	T1	.035/.089	.025/.64	.014/.36	0.438/11.13	1.00/25.40
2TXI-275	T2	.039/.99	.028/.71	.016/.41	0.438/11.13	1.00/25.40
3TXI-275	T3	.047/1.24	.034/.86	.018/.46	0.438/11.13	1.00/25.40
4TXI-275	T4	.054/1.37	.039/.99	.022/.56	0.438/11.13	1.00/25.40
5TXI-009	T5	.059/1.49	.043/1.09	.014/.36	0.438/11.13	1.00/25.40
5TXI-017	T5	.059/1.49	.043/1.09	.022/.56	0.438/11.13	1.00/25.40
5TXI-025	T5	.059/1.49	.043/1.09	.28/.71	0.438/11.13	1.00/25.40
6TXI-015	T6	.070/1.77	.050/1.29	.019/.48	0.438/11.13	1.00/25.40
6TXI-022	T6	.070/1.77	.050/1.29	.027/.69	0.438/11.13	1.00/25.40
6TXI-030	T6	.070/1.77	.050/1.29	.030/.76	0.438/11.13	1.00/25.40
6TXI-035	T6	.070/1.77	.050/1.29	.038/.97	0.438/11.13	1.00/25.40
7TXI-015	T7	.082/2.08	.060/1.52	.022/.56	0.438/11.13	1.00/25.40
7TXI-020	T7	.082/2.08	.060/1.52	.027/.69	0.438/11.13	1.00/25.40
7TXI-025	T7	.082/2.08	.060/1.52	.030/.76	0.438/11.13	1.00/25.40
7TXI-027	T7	.082/2.08	.060/1.52	.037/.94	0.438/11.13	1.00/25.40
7TXI-030	T7	.082/2.08	.060/1.52	.035/.89	0.438/11.13	1.00/25.40
7TXI-035	T7	.082/2.08	.060/1.52	.040/1.02	0.438/11.13	1.00/25.40
8TXI-018	T8	.095/2.41	.069/1.75	.025/.64	0.563/14.30	1.00/25.40
8TXI-020	T8	.095/2.41	.069/1.75	.027/.69	0.563/14.30	1.00/25.40
8TXI-025	T8	.095/2.41	.069/1.75	.030/.76	0.563/14.30	1.00/25.40
8TXI-028	T8	.095/2.41	.069/1.75	.035/.89	0.563/14.30	1.00/25.40
8TXI-030	T8	.095/2.41	.069/1.75	.037/.81	0.563/14.30	1.00/25.40
8TXI-033	T8	.095/2.41	.069/1.75	.038/.97	0.563/14.30	1.00/25.40
8TXI-040	T8	.095/2.41	.069/1.75	.40/1.02	0.563/14.30	1.00/25.40
8TXI-043	T8	.095/2.41	.069/1.75	.481/1.22	0.563/14.30	1.00/25.40
9TXI-029	T9	.102/2.59	.074/1.88	.034/.86	0.563/14.30	1.00/25.40
9TXI-032	T9	.102/2.59	.074/1.88	.037/.94	0.563/14.30	1.00/25.40
9TXI-035	T9	.102/2.59	.074/1.88	.043/1.09	0.563/14.30	1.00/25.40

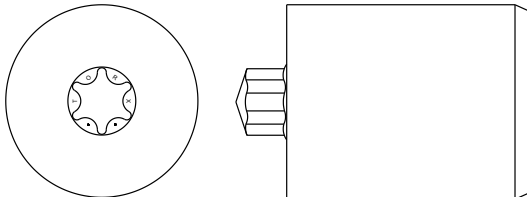

**1. Punch materials:**

- M2 at RC 61-64
- M42 at RC 63-65

**2. Special penetrations available. Specify required penetration when ordering.**

**3. Oversize available for heavy plating or hot heading applications.**

**4. PVD Coatings available for cold & hot heading applications.**